

TECHNICAL DATA

| Name | | PFMS2000 | PFMS2500 | PFMW2500 | PFMS3300 |
|---|----------------|--|--------------------|---------------|--------------|
| Collectortype | | Modular flat collector | | | |
| Mounting type | | on-roof | in-roof or on-roof | on-roof | on-roof |
| Gross area | m ² | 2,01 | 2,55 | 2,55 | 3,31 |
| Aperture area | m ² | 1,89 | 2,41 | 2,41 | 3,14 |
| Absorber area | m ² | 1,86 | 2,38 | 2,38 | 3,10 |
| Length | mm | 1700 | 2160 | 1180 | 2800 |
| Width (incl. fittings) | mm | 1180 | 1180 | 2160 | 1180 |
| Height | mm | 62 | 62 | 62 | 62 |
| Weight (empty) | kg | 33 | 42 | 42 | 53 |
| Collector capacity | l | 1,41 | 1,672 | 2,264 | 1,952 |
| max. operating pressure | bar | 10 | 10 | 10 | 10 |
| Collector field piping | | portrait format max. 10 pcs in series, landscape format: max. 6 pcs in series | | | |
| Collector incline | ° | 18 - 70 | | | |
| Connections | | 4 connections copper 22 mm with expansion of pipe end to quick connector | | | |
| Absorber | | Full-area laser-welded meander absorber (incl. elbow welding) with high-selectivity PVD coating, meandering flow, best solar yield guaranteed | | | |
| Collector housing | | Weather-resistant with aluminium rear panel guarantees long service life and high reliability (max. snow load pressure 300 kg/m ²) | | | |
| Heat insulation | | 25 mm mineral wool | | | |
| Solar Keymark Reg. N° | | 011-7S 2393F | 011-7S 2395F | 011-7S 23963F | 011-7S 2397F |
| optical efficiency eta ₀ | % | 80 | 81 | 80 | 81 |
| Collector efficiency acc. to ErP Lot1 dT 40K@1000W/m ² | % | 62 | 63 | 61 | 64 |

CROSS SECTION

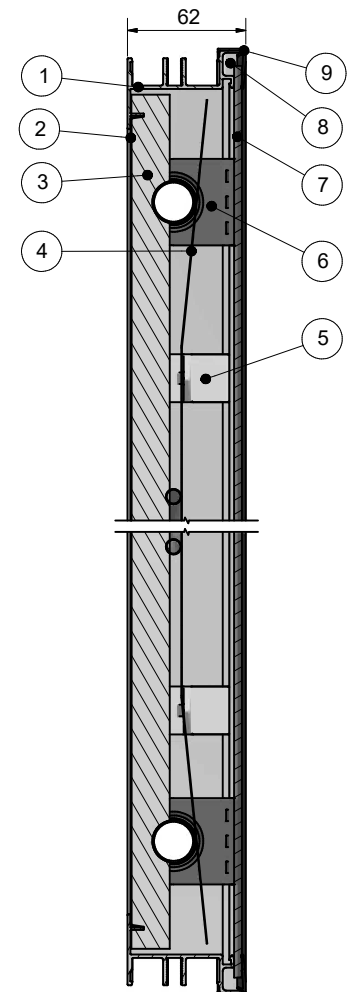

- 1 Aluminium frame section
- 2 Aluminium rear panel
- 3 Thermal insulation
- 4 Absorber
- 5 Absorber pressure pad
- 6 Frame duct
- 7 Glass pane
- 8 2-component silicone seal
- 9 Cover strip

CONNECTION

